



OPERATING & ASSEMBLY INSTRUCTION

powerCON® | Locking 3 pole Power Connector

A. OPERATING INSTRUCTION

IMPORTANT SAFETY INSTRUCTION:

The powerCON system is certified as connector without breaking capacity according IEC 61984 / VDE 0627. In this standard the term connector (without breaking capacity) refers to components which in normal use are not to be engaged or disengaged when under load or live.

Connector Combination & Keyways:

With the two non-interchangeable types of connectors (A type and B type) it is impossible to produce a short circuit. Mating connectors (combination) are identified by mechanical keyways and by color.

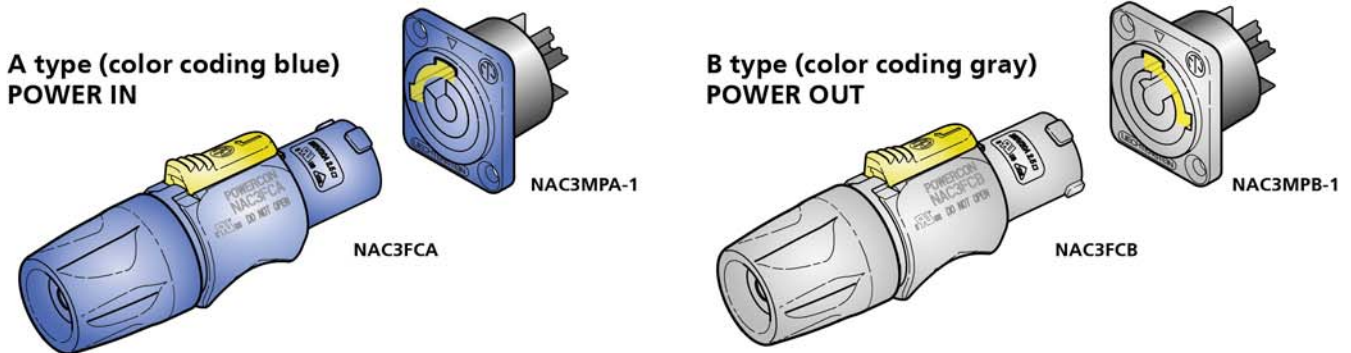

B. ASSEMBLY INSTRUCTION

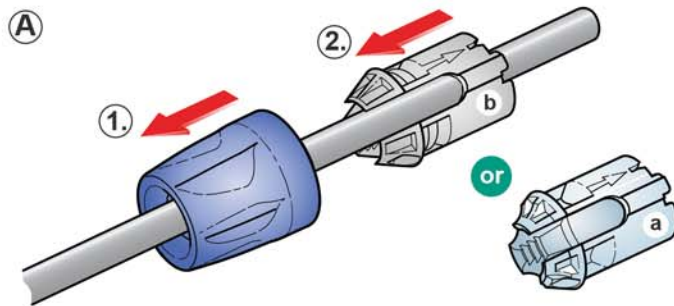

A Place the bushing (1) and the chuck (2) over the cable.

White chuck (a): 6.0 - 11.0 mm [0.236 - 0.433"]
Black chuck (b): 9.5 - 15.0 mm [0.374 - 0.59"]
VDE: 9.5 - 14.0 mm [0.374 - 0.551"]

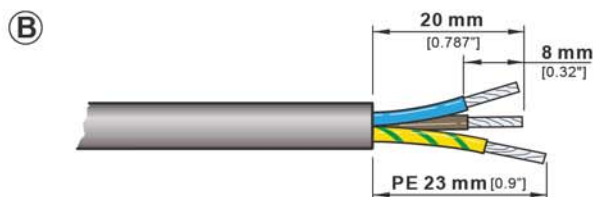

B Prepare the cable as shown.

Cable O.D.: 6.0 - 15.0 mm [0.236 - 0.59"]
Wire size: 2.5 mm² (AWG 14)

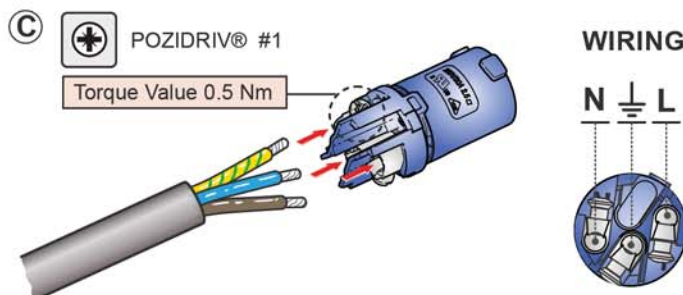

C Insert the wire into the terminals and fasten the clamping device with a POZIDRIV® #1, max. Torque 0.5 Nm (0.37 lb-ft).





D

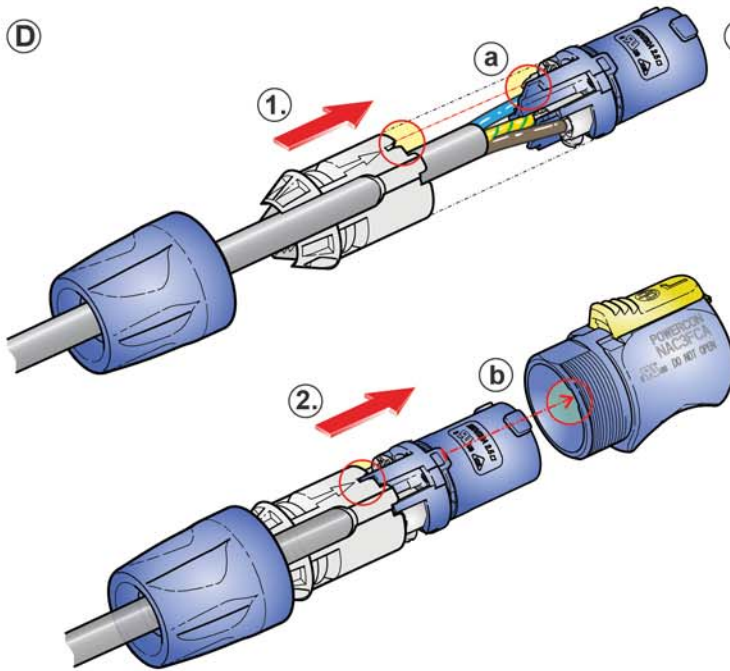

D Slide the insert and the chuck (1) into the housing (2).

Important:
(a) Align the chuck by positioning the nose into the recess.
(b) Pay attention to the guiding keyway!

E

Wrench size
7/8" (SW22)

Torque Value 2.5 Nm

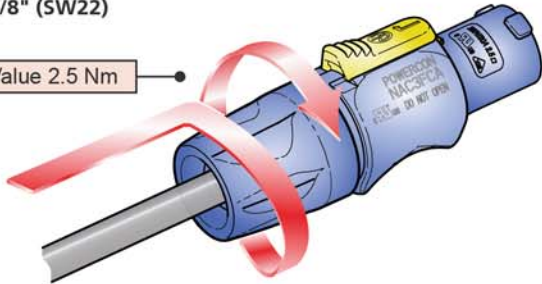

E Fasten bushing by means of a fork wrench 7/8" (SW 22), min. Torque 2.5 Nm (1.8 lb-ft).

FINISHED powerCON

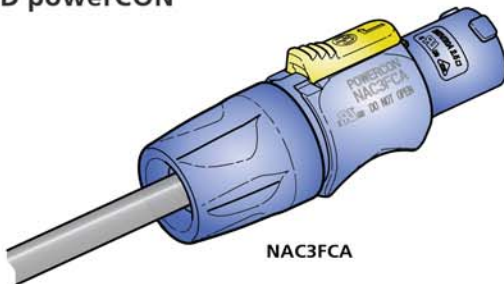

NAC3FCA

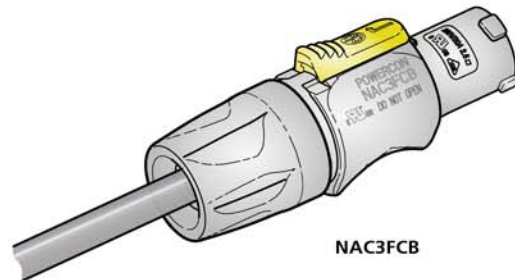

NAC3FCB

