



# OPERATING & ASSEMBLY INSTRUCTION

## powerCON® | Locking 3 pole Power Connector

### A. OPERATING INSTRUCTION

#### IMPORTANT SAFETY INSTRUCTION:

The powerCON system is certified as connector without breaking capacity according IEC 61984 / VDE 0627. In this standard the term connector (without breaking capacity) refers to components which in normal use are not to be engaged or disengaged when under load or live.

#### Connector Combination & Keyways:

With the two non-interchangeable types of connectors (A type and B type) it is impossible to produce a short circuit. Mating connectors (combination) are identified by mechanical keyways and by color.

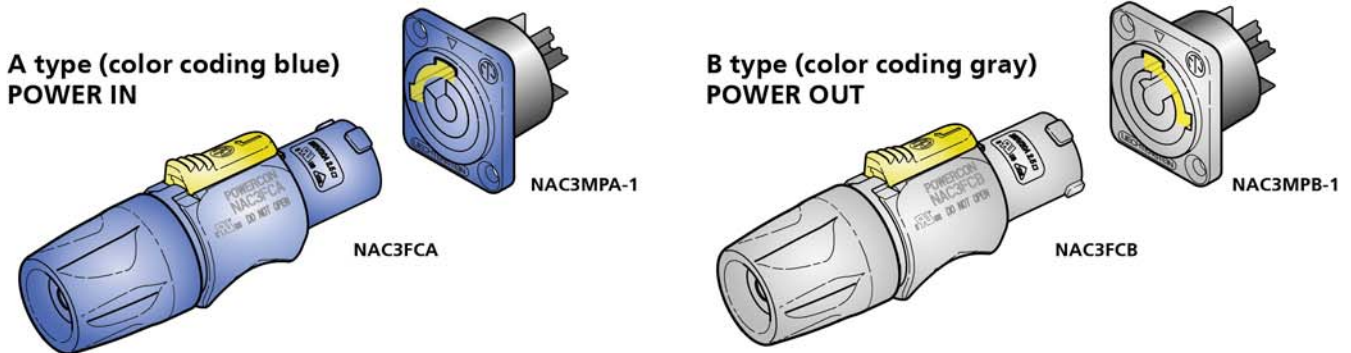

### B. ASSEMBLY INSTRUCTION

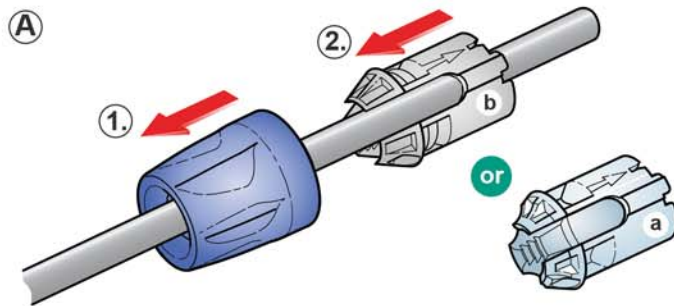

**A** Place the bushing (1) and the chuck (2) over the cable.

White chuck (a): 6.0 - 11.0 mm [0.236 - 0.433"]  
Black chuck (b): 9.5 - 15.0 mm [0.374 - 0.59"]  
VDE: 9.5 - 14.0 mm [0.374 - 0.551"]

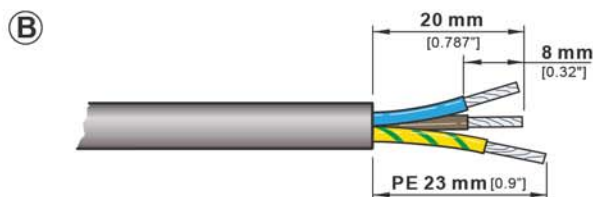

**B** Prepare the cable as shown.

Cable O.D.: 6.0 - 15.0 mm [0.236 - 0.59"]  
Wire size: 2.5 mm<sup>2</sup> (AWG 14)

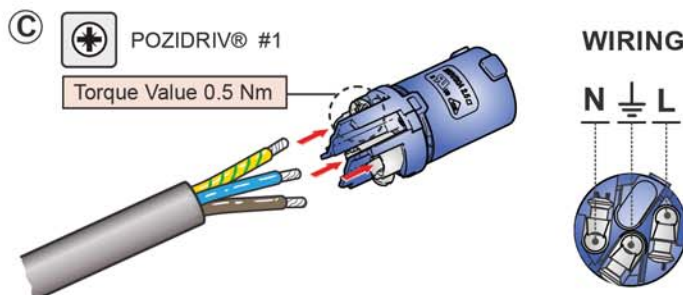

**C** Insert the wire into the terminals and fasten the clamping device with a POZIDRIV® #1, max. Torque 0.5 Nm (0.37 lb-ft).





D

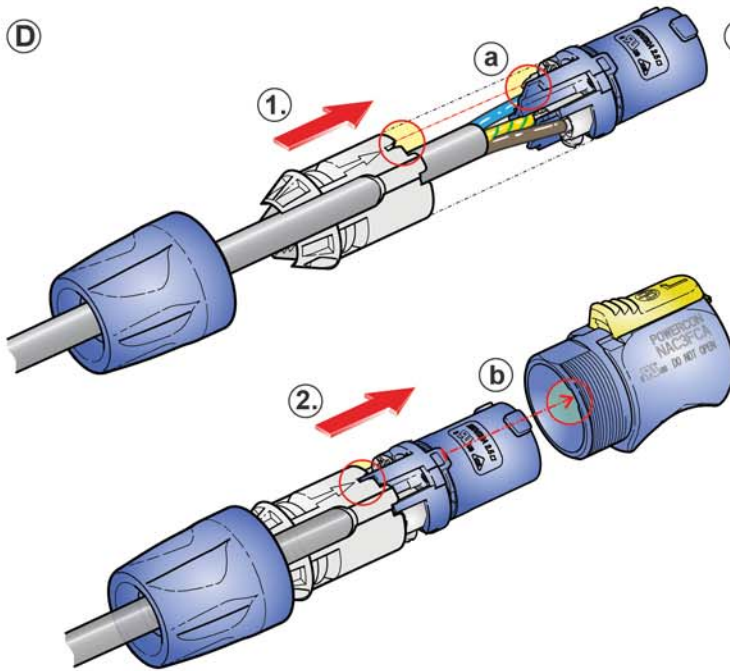

D

Slide the insert and the chuck (1) into the housing (2).

**Important:**

- (a) Align the chuck by positioning the nose into the recess.
- (b) Pay attention to the guiding keyway!

E



Wrench size  
7/8" (SW22)

Torque Value 2.5 Nm

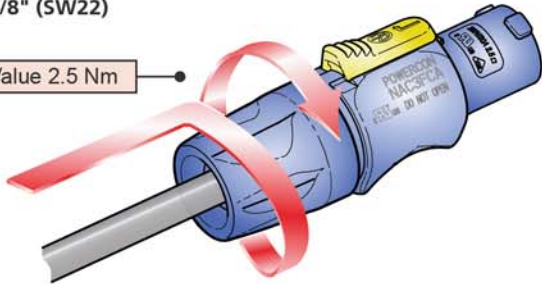

E

Fasten bushing by means of a fork wrench 7/8" (SW 22), min. Torque 2.5 Nm (1.8 lb-ft).

**FINISHED powerCON**

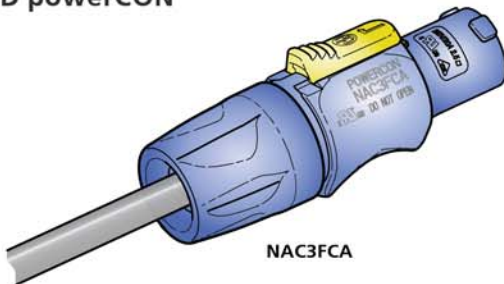

NAC3FCA

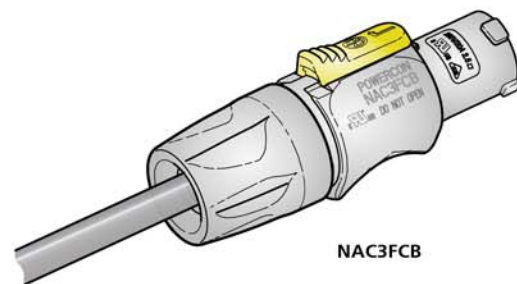

NAC3FCB

