



OPERATING & ASSEMBLY INSTRUCTION

NAC3MX-W-TOP | powerCON® TRUE1 TOP

A. APPLICATION INSTRUCTION

Application:

The powerCON TRUE1 system is certified as a connector with breaking capacity according IEC 60320, VDE 0625. It is intended for use as an appliance coupler and interconnection coupler. It serves to supply power to an appliance and from an appliance to other equipment. To be installed by qualified person only.

CONNECTOR ASSIGNMENT:

APPLIANCE INLET

NAC3MPX-TOP
NAC3MPX-WOT-TOP

Power IN

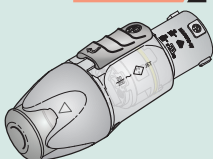

NAC3FX-W-TOP
(Connector)

APPLIANCE OUTLET

NAC3FPX-TOP
NAC3FPX-WOT-TOP
NAC3FPX-ST-TOP

Power OUT

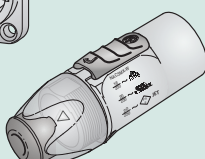

NAC3MX-W-TOP
(Plug connector)

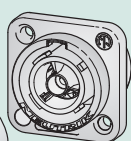

NAC3FX-W-TOP
(Connector)

APPLIANCE INLET / OUTLET ► Combination

NAC3PX-TOP

Power IN

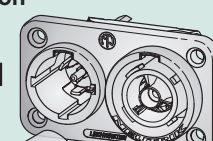

Power OUT

NAC3MX-W-TOP
(Plug connector)

powerCON TRUE1 TOP line is full backward compatible with the preceding powerCON TRUE1 products.

Approval based:

VDE

EN 60320-1/EN60320-2-2



UL

UL 498 / CSA C22.2 No. 182.3



Rating:

250 V ac / 16 A

250 V ac / 20 A

Cable Type:

H05VV-F3G 1.0 mm², Length max. 2 m

SJTOW, SJOOW 3 x 12 AWG

H05VV-F3G 1.5 - 2.5 mm²

H07RN-F3G 1.5 mm²

Strain Relief:

White chuck

White chuck

Cable O.D.:

6.0 - 12.0 mm

6.0 - 12.0 mm

UL50E environmental rating

Enclosure Type 4 when mated with cord connector NAC3FX-W-TOP or mated with appliance outlet NAC3FPX*-TOP with sealing cover SCNAC-FPX and NAC3PX-TOP with sealing cover SCNAC-PX.

B. ASSEMBLY INSTRUCTION

- A** Insert cable into the bushing and housing.

Note: "Apply cable pulling lubricant to cable jacket."

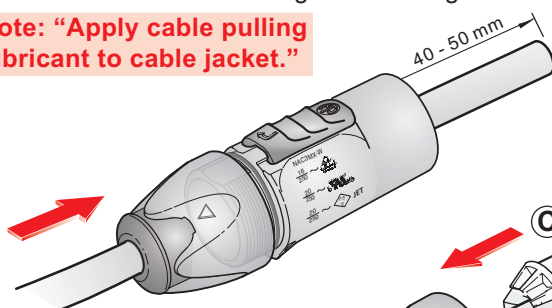

- B** Separate the housing from the bushing (cable remain in bushing)

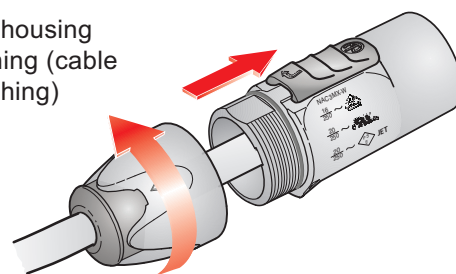

- C** Place the chuck over the cable.

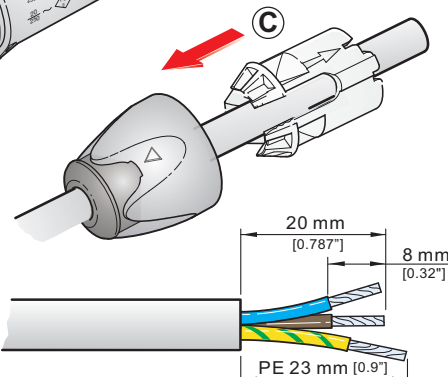

- D** Prepare the cable as shown.

i Recommendation:
Wire Pulling Lubricant - LUB-I/0.95 from 3M™

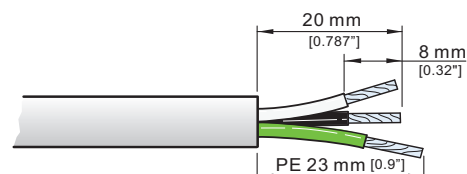



E

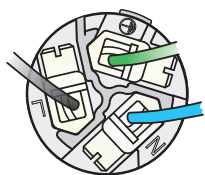

Torx size
T8

Torque Value 0.7 Nm

Insert the wires into the terminals and fasten the screw with Torx size T8.

Wiring	VDE	UL
L ⇒	brown	black
N ⇒	blue	white
⏏ ⇒	green / yellow	green

F

Important:
Push and turn simultaneously.

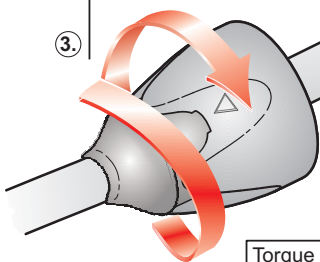

Important:
Align rubber key
and latch.

Slide the chuck onto the insert (1) and then both together into housing (2).

Important: Align the chuck and insert by positioning the nose into the keyway.

G

Torque Value 2.0 Nm

PRESS FIRMLY



Wrench size
13 mm

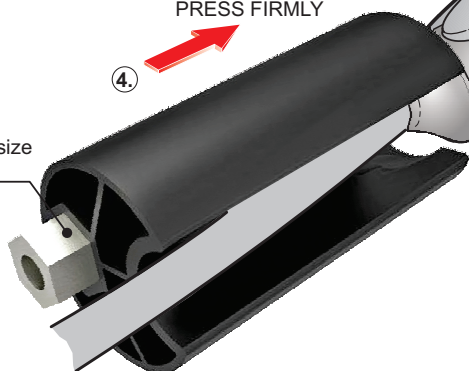

Slide the bushing up the cable and tighten it with the tool as shown.

Important: Black O-ring to hide to achieve IP protection (6).

(Tool available: Art. No. HTAC)

Find more details of powerCON TRUE1 TOP on www.neutrik.com.

FOR DISASSEMBLY - OPEN TWIST LOCK!

1. Press with screw driver to unlock
2. Turn bushing 360°.
3. Repeat step 1+2 until bushing is unscrewed.

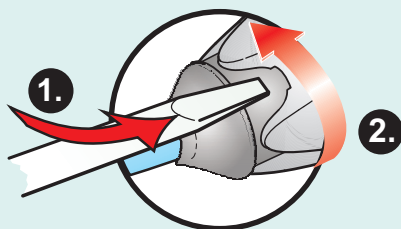

CAUTION

To ensure protection category, do not expose the connection to bending forces (e.g. do not attach loads to the cable, no free-dangling cable windings etc.).

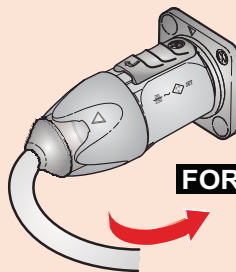

SAFETY WARNING

For safety and certification reasons the connector must be replaced in case of any broken parts or excessive wear and tear.